

DANSEAL A/S

KIRSTINEHØJ 38 C – DK-2770 KASTRUP – TLF.: 32527100



The advertisement features a central image of an open aluminum carrying case filled with various sizes of stainless steel shims. To the right, the closed case is shown with the 'STEELSHIM' logo and a stylized ship icon. Below the case, several individual shims are displayed in a row. The background is a light yellow with teal accents. The text 'STEELSHIM' is prominently displayed in a large, bold, white font with a teal outline, with the tagline 'Solid, stainless steel shims' underneath. On the right side, the text 'For shipbuilding and industry' is written vertically.

STEELSHIM
Solid, stainless steel shims

For shipbuilding and industry



CHESTERTON GORE-TEX® Grafoil® FRENZELIT

The solid, stainless steel Steelshim® shims are invaluable when aligning machinery. Cutting your own shims is time consuming and carries a risk of injury. They come in a range of sizes and thicknesses and, for convenience, are packed in a handy suitcase. They are thus readily available for the next alignment job.

Steelshim® are solid stainless steel shims produced of AISI 301 (1.4310), DIN 59381, DIN 17441 and AISI 304 (1.4301), DIN 59382, DIN 17441 and are supplied in packages of each 20 pieces.

	A	B	C	D		A	B	C	D
	mm	mm	mm	mm		mm	mm	mm	mm
StS A-005	55	50	15	0.05	StS B-005	75	70	23	0.05
StS A-010	55	50	15	0.10	StS B-010	75	70	23	0.10
StS A-020	55	50	15	0.20	StS B-020	75	70	23	0.20
StS A-040	55	50	15	0.40	StS B-040	75	70	23	0.40
StS A-050	55	50	15	0.50	StS B-050	75	70	23	0.50
StS A-070	55	50	15	0.70	StS B-070	75	70	23	0.70
StS A-100	55	50	15	1.00	StS B-100	75	70	23	1.00
StS A-200	55	50	15	2.00	StS B-200	75	70	23	2.00
StS C-005	90	80	32	0.05	StS D-005	125	105	44	0.05
StS C-010	90	80	32	0.10	StS D-010	125	105	44	0.10
StS C-020	90	80	32	0.20	StS D-020	125	105	44	0.20
StS C-040	90	80	32	0.40	StS D-040	125	105	44	0.40
StS C-050	90	80	32	0.50	StS D-050	125	105	44	0.50
StS C-070	90	80	32	0.70	StS D-070	125	105	44	0.70
StS C-100	90	80	32	1.00	StS D-100	125	105	44	1.00
StS C-200	90	80	32	2.00	StS D-200	125	105	44	2.00

**STEELSHIM®
SHIMS ARE
PERFECT
COMPLEMENTARY
TO LASER
ALIGNMENT
SYSTEMS**

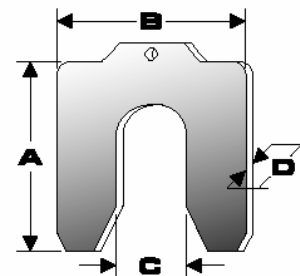

STEELSHIM® can also be delivered in a handy suitcase, containing a complete insert for storing your shims.

StS ABCD	Contains 640 shims with thicknesses from 0.05 till 2.0 mm of the A-B-C-D types.
StS AB	Contains 320 shims with thicknesses from 0.05 till 2.0 mm of the A-B types.
StS BC	Contains 320 shims with thicknesses from 0.05 till 2.0 mm of the B-C types.
StS CD	Contains 320 shims with thicknesses from 0.05 till 2.0 mm of the C-D types.
StS LEEG	Contains only a complete insert for storing your shims.